

Dispensing Nozzle Custom Configurations

Standard Configuration (ARQUE®)

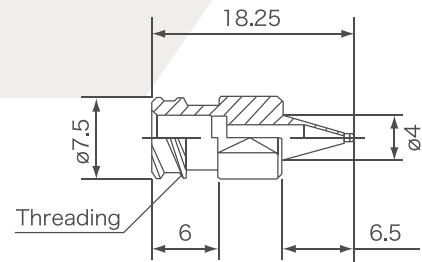

Customizable Features

Units: mm

Features	Specifications
Inner Tip Length(TL1)	1)See the below table for available lengths 2)TL1 and TL2 are the same length by default.
Outer Tip Length(TL2)	Please inquire for different lengths.
Inner Diameter(ϕd)	$\phi d \geq 0.1$
Outer Diameter 1($\phi D1$)	$\phi D1 \geq \phi d + 0.05$
Outer Diameter 2($\phi D2$)	$\phi d + 0.1 \leq \phi D2 < \phi 1.0$
Threading	Luer lock or metric screw thread upon request.

Tip Dimensions

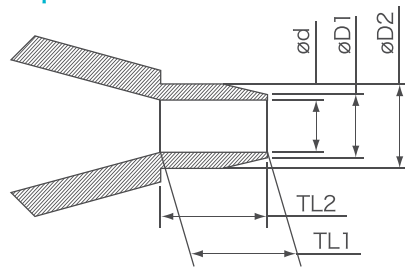

Units: mm

Inner Diameter (ϕd)	Maximum inner tip length (TL1)
0.10	2
0.11	2
0.12	2.5
0.13	2.5
0.14	2.5
0.15	3.5
0.16	3.5
0.17	4.0
0.18	4.0
0.19	4.0
0.20	5.6
0.21	5.6
0.22	5.6
0.23	5.6
0.24	5.6
0.25	6.6
0.26	6.6
0.27	6.6
0.28	6.6
0.29	6.6
0.30	8.7
0.31	8.7
0.32	8.7
0.33	8.7
0.34	8.7
0.35	9.7
0.36	9.7
0.37	9.7
0.38	9.7
0.39	9.7
0.40~0.50	11.7

Other

Smallest Lot Size	1pc
Material	SS303
Packaging	Individually Packaged

Please inquire us for any other custom requirements.

TECDIA INC.

2255 S Bascom Ave, Ste 120 Campbell, CA 95008, USA
T. +1 408-748-0100 F. +1 408-748-0111 E-MAIL: sales@tecdia.com

<https://us.tecdia.com/>

Information and figures contained in this catalog are subject to change without prior notice.
(2020.SEP) B-034-2

Dispensing Nozzle

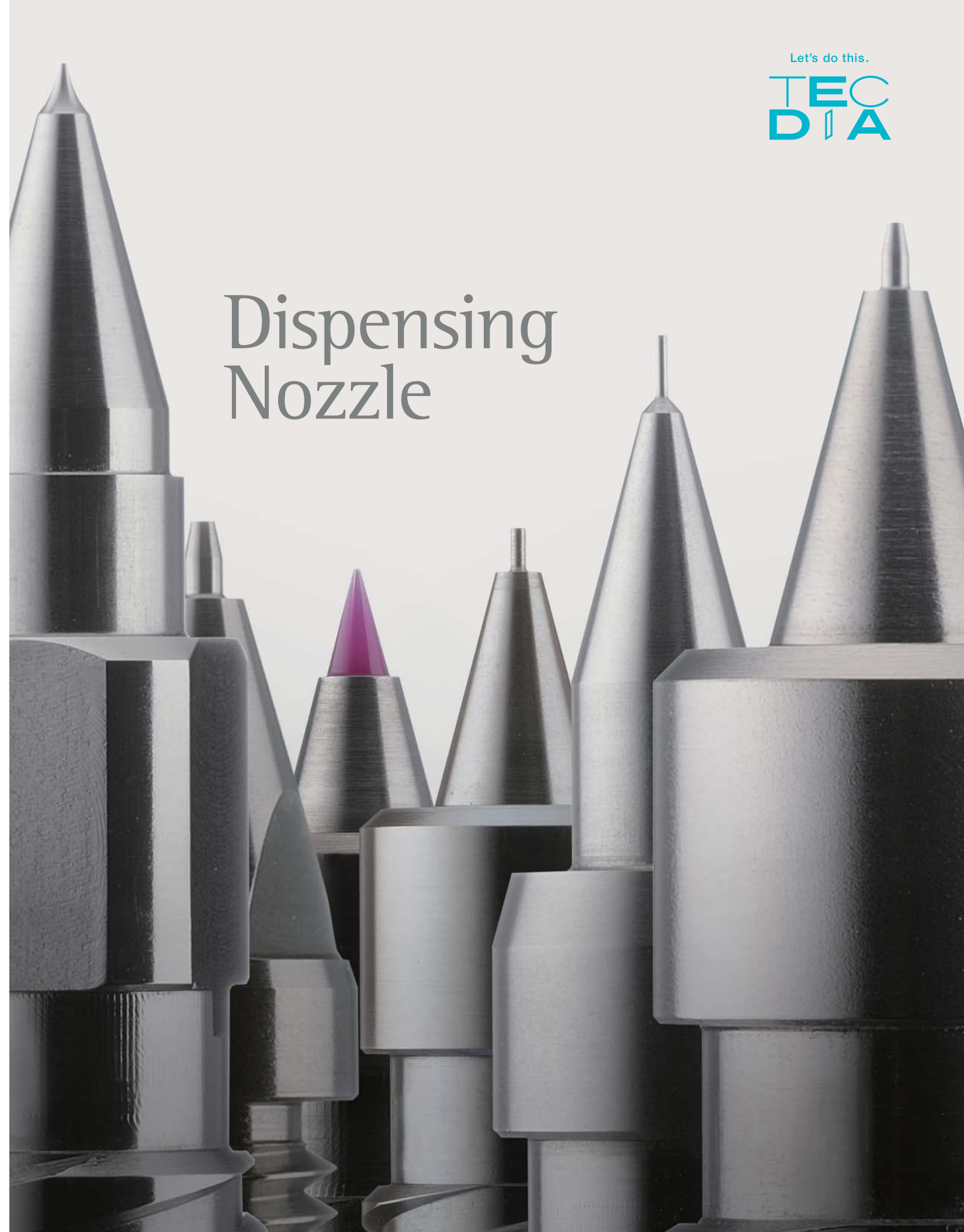

ARQUE® SERIES

Design Characteristics Tecdia's unparalleled machining tolerances realizes precision fluid dispensing with high repeat accuracy.

Internal Taper / Eliminates Clogging /

The straight and smooth internal profile eliminates material clogging caused by stepped machining. Dispensing precision is improved by increased fluid flow.



Fluid flow comparison video



Polished Tip / Prevents Creep-up /

All ARQUE® nozzles feature polished tips to decrease friction and reduce unwanted material collection that can affect shot performance.



Perfect Alignment / High Repeatability /

Joint-less interface improves pressure response between the nozzle and the syringe. The efficient use of materials leads to material cost savings.

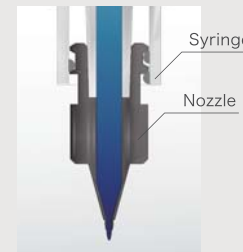

Coating Option / Eliminates Stringing /

Applying a non-stick coating to the nozzle eliminates stringing of pastes and fluid accumulation at the tip. It also helps in overcoming problems of inconsistent dispensing for certain materials.

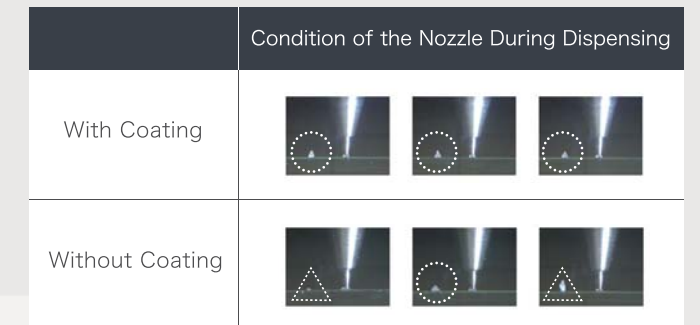

*AG Coating
Coating thickness: less than 0.01 - 0.03 um
Working Temperature: up to 120 °C

Product Lineup

Model	Part Number	Tip Size		Inner Tip Length(TL1)	Tapered Bore	Polished Tip	Syringe Bore Matching	Serial No. Engraving	Coating Option
		I.D(φd)	O.D 1(φD1)						
ARQUE	A-100200100SN-A121	0.10	0.20	1.00	○	○	○	○	○
	A-150250100SN-A122	0.15	0.25	1.00	○	○	○	○	○
	A-200300100SN-A123	0.20	0.30	1.00	○	○	○	○	○
	A-250350100SN-A124	0.25	0.35	1.00	○	○	○	○	○
	A-300400100SN-A125	0.30	0.40	1.00	○	○	○	○	○
	A-350450100SN-A126	0.35	0.45	1.00	○	○	○	○	○
	A-400500100SN-A127	0.40	0.50	1.00	○	○	○	○	○
	A-450550100SN-A128	0.45	0.55	1.00	○	○	○	○	○
	A-500600100SN-A129	0.50	0.60	1.00	○	○	○	○	○
	A-600700100SN-A432	0.60	0.70	1.00	○	○	○	○	○
ARQUE-S	A-100200000SN-A191	0.10	0.20	0.30	○	○	○	○	○
	A-150250000SN-A192	0.15	0.25	0.30	○	○	○	○	○
	A-200300000SN-A193	0.20	0.30	0.30	○	○	○	○	○
ARQUE SELECT	A-300400100SN-A742	0.30	0.40	1.00	○	○	○	-	-
	A-350450100SN-A743	0.35	0.45	1.00	○	○	○	-	-
	A-400500100SN-A744	0.40	0.50	1.00	○	○	○	-	-
	A-500600100SN-A745	0.50	0.60	1.00	○	○	○	-	-
ARQUE PREMIUM	A-600700100SN-A746	0.60	0.70	1.00	○	○	○	-	-
	A-030080000SN-A538	0.03	0.08	0.20	-	○	-	○	○
	A-050100000SN-A539	0.05	0.10	0.30	-	○	-	○	○
	A-070120000SN-A540	0.07	0.12	0.30	-	○	-	○	○
A-080130000SN-A541	0.08	0.13	0.30	-	○	-	○	○	

Units : mm

Material : SS303

Other Dispensing Nozzles

Super Long-Tipped Nozzle

Super long-tipped nozzles enable dispensing in hard-to-reach areas without compromising the benefits of ARQUE®.

Units: mm

L - 150 250 150 SN - A996

Product Category: L-150 250 150
I.D(φd): 150:0.15mm
O.D 1(φD1): 250:0.25mm
Outer Tip Length(TL2): 150:1.50mm
Body Material: SN
Surface Treatment: A996
Registration Number: A996

Part Number	Tip Size			Outer Tip Length(TL2)								
	I.D (φd)	O.D 1 (φD1)	O.D 2 (φD2)	1.50	2.00	2.50	3.00	3.50	4.00	4.50	5.00	
L-150250150SN-A996	0.15	0.25	0.45	1.50	-	-	-	-	-	-	-	
L-200300□□□SN-△△△△	0.20	0.30	0.50	1.50	2.00	-	-	-	-	-	-	
L-250350□□□SN-△△△△	0.25	0.35	0.55	1.50	2.00	2.50	-	-	-	-	-	
L-300400□□□SN-△△△△	0.30	0.40	0.60	1.50	2.00	2.50	3.00	3.50	4.00	4.50	-	
L-350450□□□SN-△△△△	0.35	0.45	0.65	1.50	2.00	2.50	3.00	3.50	4.00	4.50	5.00	
L-400500□□□SN-△△△△	0.40	0.50	0.70	1.50	2.00	2.50	3.00	3.50	4.00	4.50	5.00	
L-450550□□□SN-△△△△	0.45	0.55	0.75	1.50	2.00	2.50	3.00	3.50	4.00	4.50	5.00	
L-500600□□□SN-△△△△	0.50	0.60	0.80	1.50	2.00	2.50	3.00	3.50	4.00	4.50	5.00	

*□□□ changes depending on the outer tip length (TL2).
*△△△△ is the assigned registration number.

Material: SS303

Ruby Nozzle

Our durable ruby tip greatly improves flow rates and accuracy of the dispensed volumes due to reduced surface friction.

Units: mm

R - 050 150 000 SN - A021

Product Category: R-050 150 000
I.D(φd): 050:0.05mm
O.D 1(φD1): 150:0.15mm
Outer Tip Length(TL2): 000
Body Material: SN
Surface Treatment: A021
Registration Number: A021

Part Number	Tip Size	
	I.D(φd)	O.D 1(φD1)
R-050150000SN-A021	0.05	0.15
R-070170000SN-A032	0.07	0.17
R-080180000SN-A022	0.08	0.18
R-100200000SN-A023	0.10	0.20
R-150250000SN-A024	0.15	0.25
R-200300000SN-A025	0.20	0.30
R-250350000SN-A026	0.25	0.35
R-300400000SN-A027	0.30	0.40
R-350450000SN-A028	0.35	0.45
R-400500000SN-A029	0.40	0.50
R-450550000SN-A030	0.45	0.55
R-500600000SN-A031	0.50	0.60

Material : SS+RUBY